

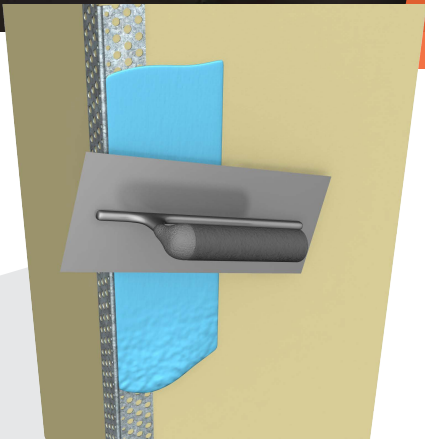

PRODUCT DATA SHEET

**RONDO®**

# EXANGLE® PLASTERING BEADS



The Rondo EXANGLE® range of plastering beads are manufactured to assist contractors in obtaining a strong, straight, knock-resistant corner with a superior finish that lasts. Available for a variety of applications including internal and external corners, shadowlines, archways, control joints, bullnose corners and edge capping.

The lower profile nib on our P01 External Corner Bead reduces the amount of compound build up on the corner, and our shadowline beads can create the impression of greater ceiling heights whilst helping to hide imperfections in the abutting walls.

## PERFORATED OR EXPANDED PROFILES / GALVABOND OR ZINCANEAL STEEL / SIMPLE INTEGRATION

### BENEFITS

- Choice of perforated or Expanded profiles.
- Nail holes on selected profiles for easy installation.
- Minimum coating of Z200.
- Made from 0.30-0.50BMT Galvabond or Zincaneal Steel to provide ideal stiffness.

### SUITABLE FOR

- Internal and External Corners (Internal Use)
- Shadowline applications
- Flashing in wet areas
- Archways
- Control Joints
- Edge capping
- Bullnose corners

RONDO

STANDARDS & CODES	CEILING					WALLS			ACCESSORIES	FINISHING SECTIONS		ACCESS PANELS
	DONN	KEY-LOCK	XPRESS	WALK-ABOUT	STUD & TRACK	STUD & TRACK	MAXIFRAME	QUIET STUD	TOP HATS	EXANGLE	EXANGLE RT	PANTHER
<b>NCC 2022</b> - Building Code of Australia Volumes 1 & 2												
<b>NZBC - B1/VM1</b> NZ Building Code Verification Method B1/VM1 Clause 2												
<b>NZBC - B2</b> Durability Rondo XPRESS® Drywall Grid System will have a minimum serviceable life of 15 years when installed in a dry, non-corrosive, interior installation.												
<b>AS/NZS 1170.0:2002</b> Part 0: General principles												
<b>AS/NZS 1170.1:2002</b> Part 1: Permanent, imposed & other actions												
<b>AS/NZS 1170.2:2021</b> Part 2: Wind actions												
<b>AS 1170.4:2007</b> Part 4: Earthquake actions in Australia												
<b>NZS 1170.5:2004</b> Part 5: Earthquake actions in New Zealand												
<b>NZS 4219:2009</b> Seismic performance of engineering systems in buildings												
<b>AS/NZS 4055:2021</b> Wind loads for housing												
<b>AS/NZS 4600:2018</b> Cold formed steel structures												
<b>AS/NZS 2785:2020</b> Suspended Ceilings - Design & installation												
<b>AS 3566.1:2002</b> Self-drilling screws for the building and construction industries - General requirements and mechanical properties												
<b>AS 5216:2021</b> Design of post-installed and cast-in fastenings in concrete												
<b>AS1530.4:2014</b> Fire resistance tests for elements of construction												
<b>AS/NZS 1530.3:1999</b> Simultaneous determination of ignitability, flame propagation, heat release and smoke release (Reconfirmed 2016)												
<b>AS 1191:2002</b> Acoustics - Method for laboratory measurement of airborne sound transmission insulation of building elements												
<b>AS/NZS ISO 717.1:2004</b> Acoustics - Airborne sound insulation												

STRUCTURAL DESIGN ACTIONS

STANDARDS & CODES	CEILING					WALLS			ACCESSORIES	FINISHING SECTIONS		ACCESS PANELS
	DONN	KEY-LOCK	XPRESS	WALK-ABOUT	STUD & TRACK	STUD & TRACK	MAXIFRAME	QUIET STUD	TOP HATS	EXANGLE	EXANGLE RT	PANTHER
<b>ASTM C635/C635M-17</b> Standard Specification for Manufacture, Performance and Testing of Metal Suspension Systems for Acoustical Tile and Lay-in Panel Ceilings												
<b>AS 3623:1993</b> Domestic metal framing												
<b>AS/NZS 1657:2018</b> Fixed platforms, walkways, stairways & ladders. Design, construction & installation												
<b>AS/NZS 1397:2021</b> Continuous hot-dip metallic coated steel sheet & strip - Coatings of zinc & zinc alloyed with aluminium & magnesium												
<b>AS/NZS 1664.1:1997</b> Aluminium structures - Limit state design												
<b>AS/NZS 1866:1997</b> Aluminium & aluminium alloys - Extruded rod, bar, solid & hollow shapes												
<b>AS/NZS 2311:2017</b> Guide to the painting of buildings												
<b>AS/NZS 2589:2017</b> Gypsum Linings - Application & finishing												

## MATERIAL SAFETY DATA INFORMATION

### MATERIALS

Products manufactured by Rondo Building Services are produced from coated steel coil material which is classified as a non-hazardous material.

### PRODUCTION PROCESSES

A water-based soluble lubricant is used to assist with the roll forming process. These soluble lubricants are not considered hazardous when used as recommended by the manufacturer.

### HANDLING AND STORAGE

Products are supplied in pack and sub-pack quantities and should be handled in accordance with the recommendations contained in AS 1470 – Health and Safety at Work Principles and Practice.

Where mechanical lifting or moving equipment is required, trained, and licensed operators are to be used.

Metal products should be stored in an environmentally friendly area away from airborne contaminants such as acid and salt sprays.

### SAFETY

It is our recommendation that PPE should be worn when handling metal products (AS 2161 –Occupational Protective Gloves) and that they should be checked regularly for damage.

People with sensitive skin conditions should seek medical advice before prolonged handling of metal products: hands should be washed before eating and for personal hygiene.

Safety glasses (AS/NZS 1336) should be worn when cutting metal sections.

### SITE TRAINING

It is the responsibility of the contractor to ensure their employees are trained in onsite WHS procedures as these can vary from site to site.

### COMBUSTIBILITY

For more information on the steel used by Rondo visit [www.steel.com.au](http://www.steel.com.au) or [click here](#).



## RONDO WARRANTY

Rondo's quality products are backed by our comprehensive warranty.

With minimal exclusions, our warranty provides optimal peace of mind.

For more information on our warranty [click here](#).



## CERTIFICATIONS



Rondo's commitment to quality and environmental responsibility is reflected through our ISO 9001 certification.

At Rondo, we ensure compliance with laws, regulations and standards while maintaining transparent communication with stakeholders on environmental issues.

For more information on our quality assurance [click here](#).